

Alexander Blains Land.

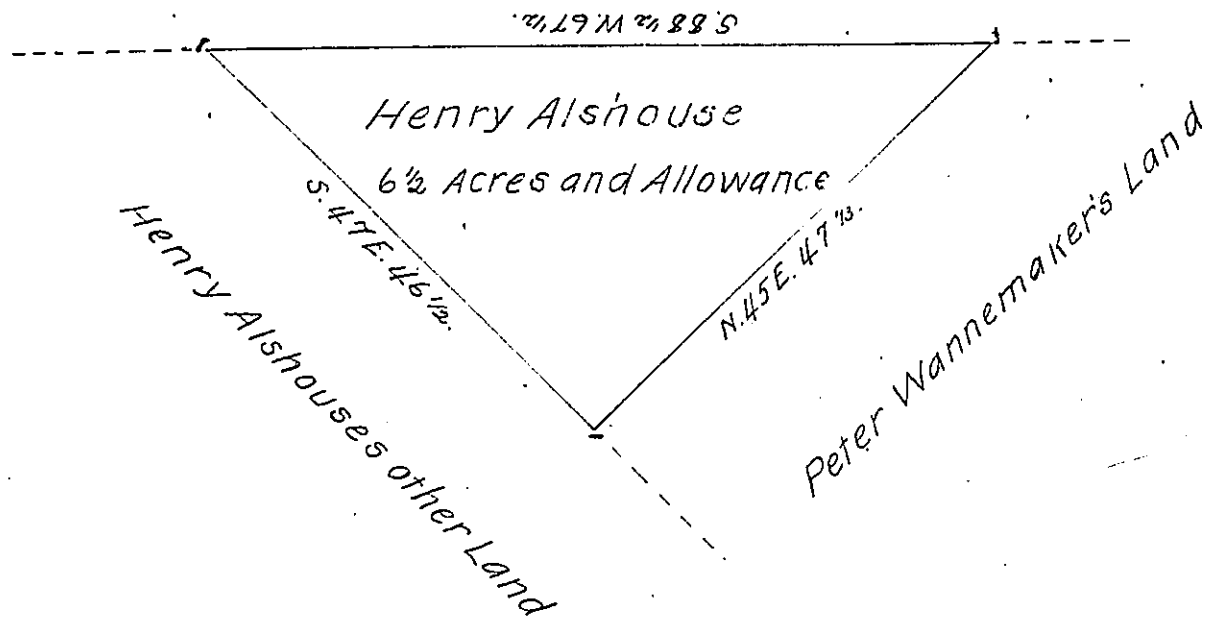

In pursuance of a Warrant dated June 5<sup>th</sup> 1821 there was Surveyd for Henry Alshouse the above described tract of Land containing Six Acres and one half of an acre with an allowance of Six p Cent Situate in Hempfield Township in the County of Westmoreland Surveyed July 7<sup>th</sup> 1821.

Samuel Cochran Esquire }  
 Survr Genl of Penna }

per Isaac Moore D.S.

IN TESTIMONY that the above is a copy of the original remaining on file in the Department of Internal Affairs of Pennsylvania, made conformably to an Act of Assembly approved the 16th day of February, 1833, I have hereunto set my Hand and caused the Seal of said Department to be affixed at Harrisburg, this Fifth day of October 1903

*Isaac R. Brown*  
 Secretary of Internal Affairs.